

ISO A1 841mm x 594mm  
 Checked: NO  
 Approved: US  
 Designer: CH  
 Checked: CH  
 Project Reference Number: 605364  
 Project Management Details:  
 Latest Revision Number:  
 Project Reference Number: 605364  
 Last saved by: NANA OFFE(2019-10-02) Last Plotted: 2019-10-02  
 Filename: A:\PROJECTS\605364-SEALR\DRAWINGS\CAD\20-SHEETS\605364-ACM-00-XX-SKE-CE-0001.DWG  
 This drawing includes Ordnance Survey material with the permission of Ordnance Survey on behalf of The Controller of Her Majesty's Stationery Office, © Crown Copyright AECOM Limited, Licence Number AL100019139  
 Printed on 85% Post-Consumer Recycled Content  
 Paper

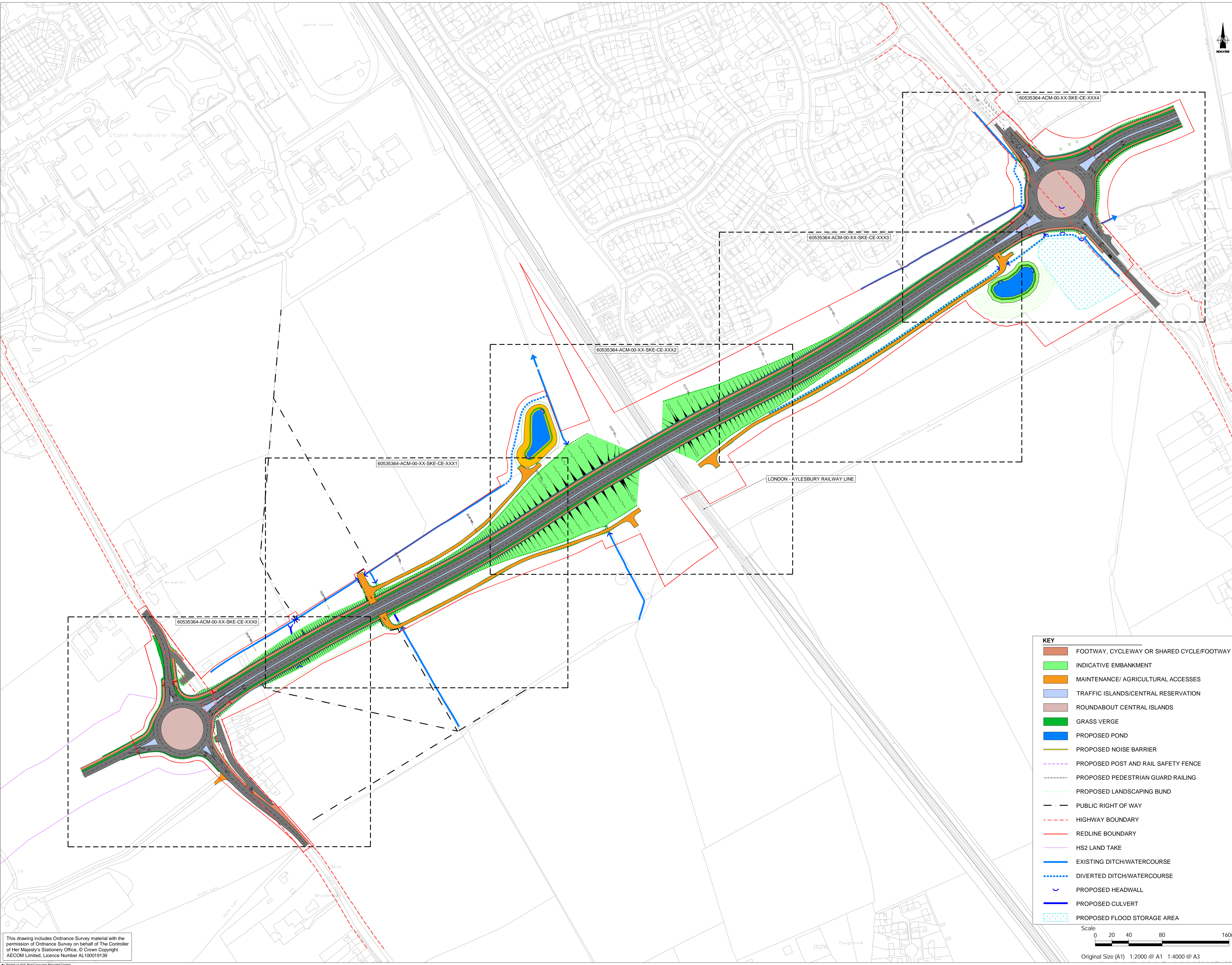

**CONSULTANT**  
 AECOM  
 3 St James Court  
 Whitefriars  
 Norwich, NR3 1RJ  
 +44 (0)1603 953000

**PROJECT**  
 SOUTH EAST  
 AYLESBURY LINK  
 ROAD (SEALR)

**CLIENT**  
 BUCKINGHAMSHIRE  
 COUNTY COUNCIL  
 County Hall,  
 Walton Street,  
 Aylesbury,  
 Buckinghamshire, HP20 1UA  
 Tel: +44 (0)129 639 5000  
 www.buckscc.gov.uk

- NOTES**
- ALL DIMENSIONS ARE IN METRES UNLESS OTHERWISE STATED.
  - THIS DRAWING IS PRELIMINARY AND SUBJECT TO A SAFETY AUDIT.
  - HIGHWAY BOUNDARY BASED ON BCC INFORMATION DATED 06/03/17 AND SHOULD BE VERIFIED.
  - DRAWING BASED ON TOPOGRAPHICAL SURVEY REF. G 8673-REV 0, PRODUCED BY LASER SURVEYS, DATED 13/04/17.

**KEY**  
 [---] SHEET LAYOUT

**KEY**

- FOOTWAY, CYCLEWAY OR SHARED CYCLE/FOOTWAY
- INDICATIVE EMBANKMENT
- MAINTENANCE/ AGRICULTURAL ACCESSES
- TRAFFIC ISLANDS/CENTRAL RESERVATION
- ROUNDABOUT CENTRAL ISLANDS
- GRASS VERGE
- PROPOSED POND
- PROPOSED NOISE BARRIER
- PROPOSED POST AND RAIL SAFETY FENCE
- PROPOSED PEDESTRIAN GUARD RAILING
- PROPOSED LANDSCAPING BUND
- PUBLIC RIGHT OF WAY
- HIGHWAY BOUNDARY
- REDLINE BOUNDARY
- HS2 LAND TAKE
- EXISTING DITCH/WATERCOURSE
- DIVERTED DITCH/WATERCOURSE
- PROPOSED HEADWALL
- PROPOSED CULVERT
- PROPOSED FLOOD STORAGE AREA

Scale  
 0 20 40 80 160m  
 Original Size (A1) 1:2000 @ A1 1:4000 @ A3

FOR APPROVAL

**ISSUE/REVISION**

NO	DATE	DESCRIPTION
A	02/10/19	FIRST ISSUE

**SHEET TITLE**  
 SOUTH EAST AYLESBURY  
 LINK ROAD OVERVIEW  
**SHEET NUMBER**  
 605364-ACM-00-XX-SKE-CE-0001  
**SCALE**  
 AS SHOWN @ A1

**CONTINUATION - REFER TO 60535364-ACM-00-XX-SKE-CE-0100-INSET A**

1. ALL DIMENSIONS ARE IN METRES UNLESS OTHERWISE STATED.
2. THIS DRAWING IS PRELIMINARY AND SUBJECT TO A SAFETY AUDIT.
3. HIGHWAY BOUNDARY BASED ON BCC INFORMATION DATED 06/03/17 AND SHOULD BE VERIFIED.
4. DRAWING BASED ON TOPOGRAPHICAL SURVEY REF. G 8673-REV 0, PRODUCED BY LASER SURVEYS, DATED 13/04/17.
5. INDICATIVE SIGNAGE AND ROAD MARKINGS SHOWN. SIGNAGE STRATEGY (INCL. DIRECTIONAL SIGNING) TO FORM PART OF THE DETAILED DESIGN.

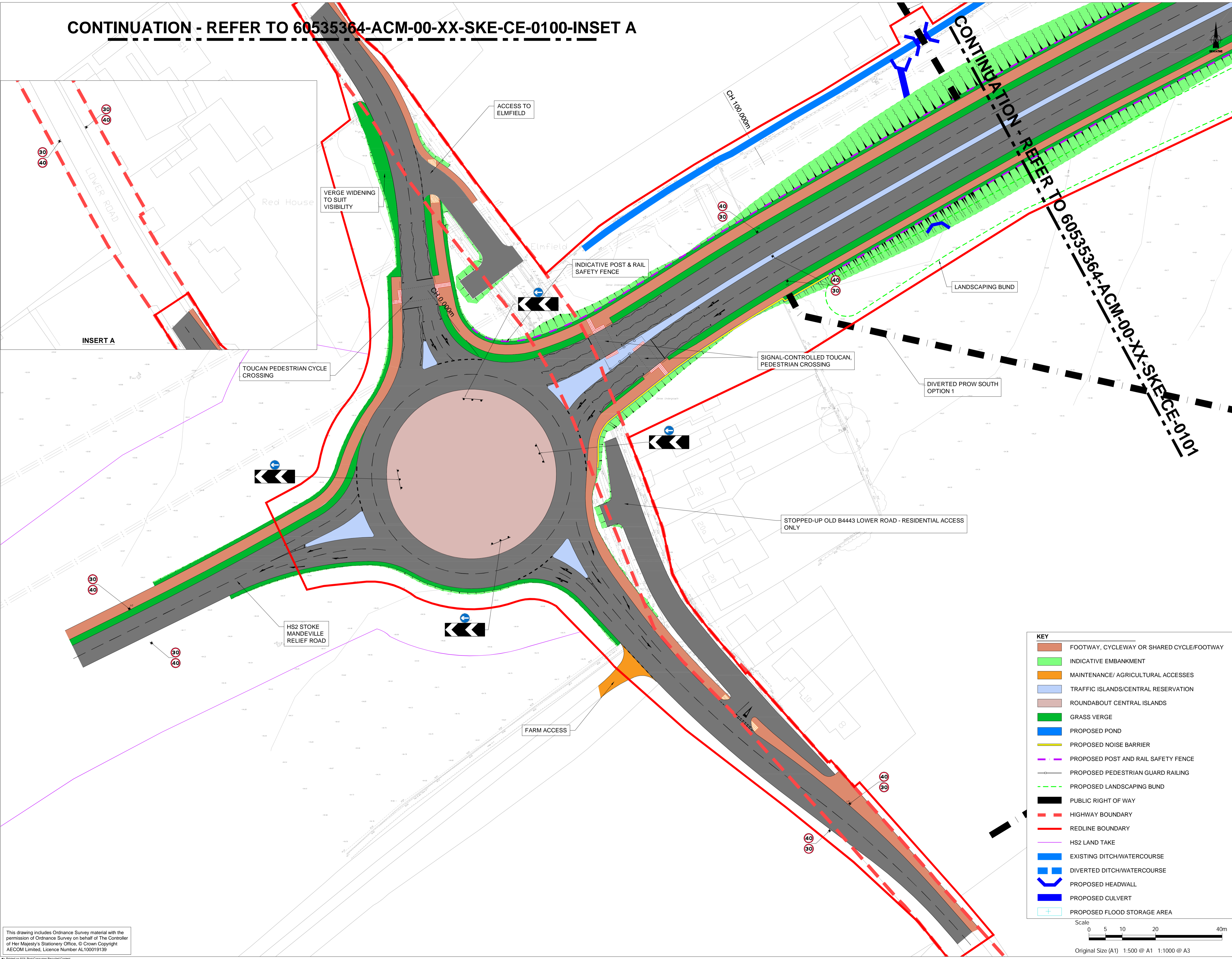

**KEY**

- FOOTWAY, CYCLEWAY OR SHARED CYCLE/FOOTWAY
- INDICATIVE EMBANKMENT
- MAINTENANCE/ AGRICULTURAL ACCESSES
- TRAFFIC ISLANDS/CENTRAL RESERVATION
- ROUNDABOUT CENTRAL ISLANDS
- GRASS VERGE
- PROPOSED POND
- PROPOSED NOISE BARRIER
- PROPOSED POST AND RAIL SAFETY FENCE
- PROPOSED PEDESTRIAN GUARD RAILING
- PROPOSED LANDSCAPING BUND
- PUBLIC RIGHT OF WAY
- HIGHWAY BOUNDARY
- REDLINE BOUNDARY
- HS2 LAND TAKE
- EXISTING DITCH/WATERCOURSE
- DIVERTED DITCH/WATERCOURSE
- PROPOSED HEADWALL
- PROPOSED CULVERT
- PROPOSED FLOOD STORAGE AREA

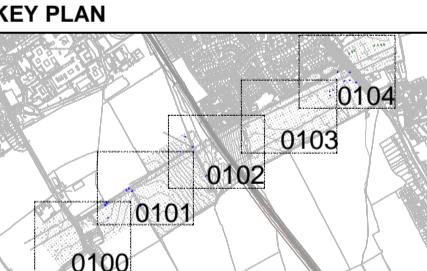
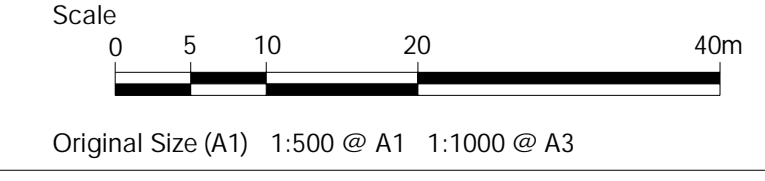

**FOR APPROVAL**

**ISSUE/REVISION**

NO	DATE	DESCRIPTION
A	02/10/19	FIRST ISSUE

**SHEET TITLE**

SOUTH EAST AYLESBURY  
GENERAL ARRANGEMENT  
SHEET 1 OF 5

**SHEET NUMBER**

60535364-ACM-00-XX-SKE-CE-0100

**SCALE**

AS SHOWN @ A1

Project Management Details: Designer: CH, Checked: NO, Approved: JS  
 Latest Revision Details: Designer: CH, Checked: NO, Approved: JS  
 Project Reference Number: 60535364  
 Last saved by: CHAMPION(2019-10-02), Last Plotted: 2019-10-02  
 Filename: A:\PROJECTS\60535364 - SEALR\DRAWINGS\CAD\20-SHEETS\60535364-ACM-00-XX-SKE-CE-0100.DWG  
 This drawing includes Ordnance Survey material with the permission of Ordnance Survey on behalf of The Controller of Her Majesty's Stationery Office, © Crown Copyright AECOM Limited, Licence Number AL100019139  
 Printed on 85% Post-Consumer Recycled Content Paper

This drawing has been prepared for the use of AECOM's client. It may not be used, modified, reproduced or relied upon by third parties, except as agreed by AECOM or as required by law. AECOM accepts no responsibility, and denies any liability, whatsoever, to any party that uses or relies on this drawing without AECOM's express written consent. Do not scale this document. All measurements must be obtained from the stated dimensions.

ISO A1 594mm x 841mm  
 Check: NO  
 Approved: US  
 Designer: CH  
 Checked: CH  
 Project Reference Number: 6053364

CONSULTANT  
 AECOM  
 3 St James Court  
 Whitefriars  
 Norwich, NR3 1RJ  
 +44 (0)1603 953000

PROJECT  
**SOUTH EAST  
 AYLESBURY LINK  
 ROAD (SEALR)**

CLIENT  
**BUCKINGHAMSHIRE  
 COUNTY COUNCIL**  
 County Hall,  
 Walton Street,  
 Aylesbury,  
 Buckinghamshire, HP20 1UA  
 Tel: +44 (0)129 639 5000  
 www.buckscc.gov.uk

- NOTES
1. ALL DIMENSIONS ARE IN METRES UNLESS OTHERWISE STATED.
  2. THIS DRAWING IS PRELIMINARY AND SUBJECT TO A SAFETY AUDIT.
  3. HIGHWAY BOUNDARY BASED ON BCC INFORMATION DATED 06/03/17 AND SHOULD BE VERIFIED.
  4. DRAWING BASED ON TOPOGRAPHICAL SURVEY REF. G 8673-REV 0, PRODUCED BY LASER SURVEYS, DATED 13/04/17.
  5. INDICATIVE SIGNAGE AND ROAD MARKINGS SHOWN. SIGNAGE STRATEGY (INCL. DIRECTIONAL SIGNING) TO FORM PART OF THE DETAILED DESIGN.

Last saved by: CHAMPIONR(2019-10-02) Last Plotted: 2019-10-02  
 Filename: A:\PROJECTS\6053364 - SEALR\DRAWINGS\CAD\20-SHEETS\6053364-ACM-00-XX-SKE-CE-0100.DWG

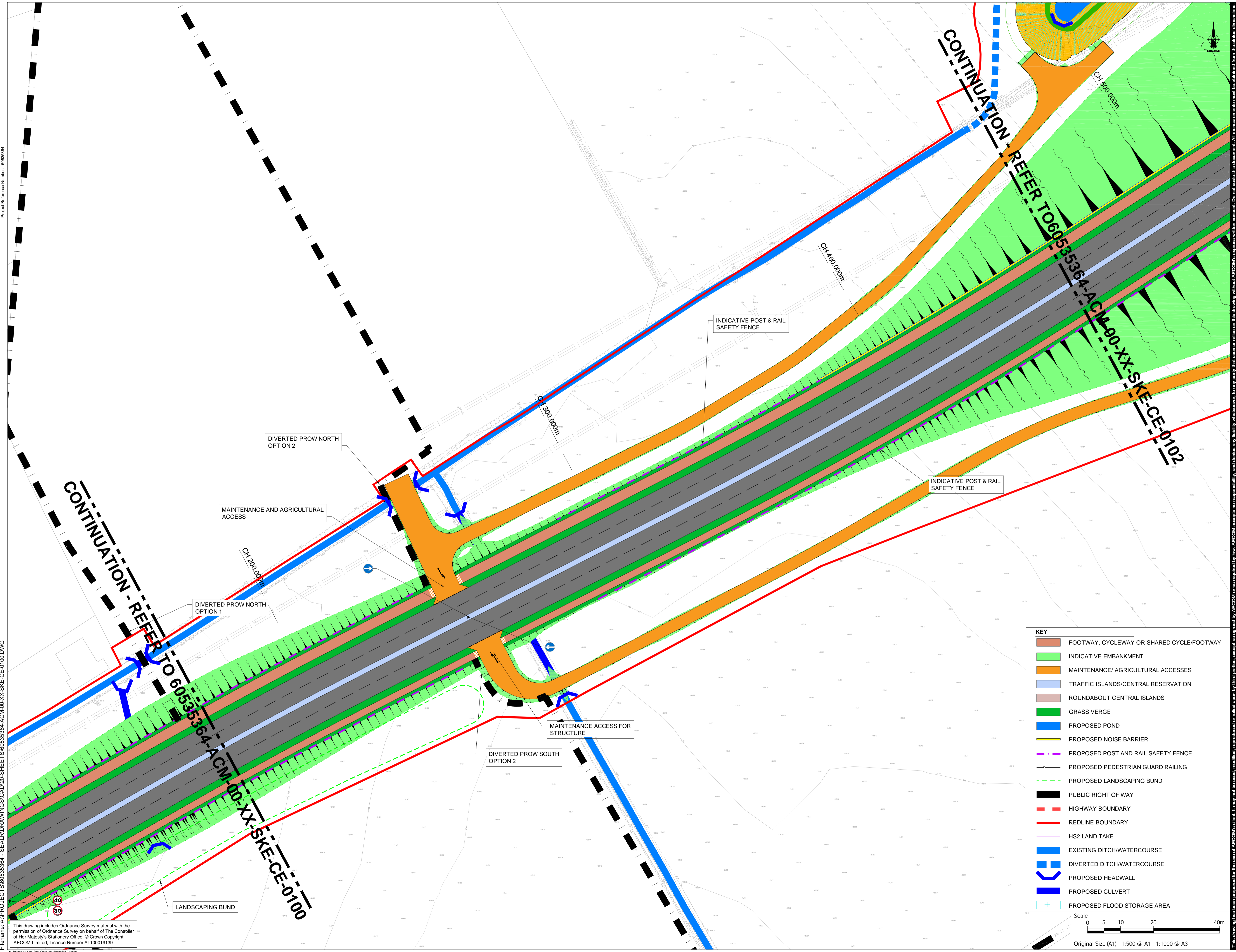

**KEY**

- FOOTWAY, CYCLEWAY OR SHARED CYCLE/FOOTWAY
- INDICATIVE EMBANKMENT
- MAINTENANCE/ AGRICULTURAL ACCESSES
- TRAFFIC ISLANDS/CENTRAL RESERVATION
- ROUNDABOUT CENTRAL ISLANDS
- GRASS VERGE
- PROPOSED POND
- PROPOSED NOISE BARRIER
- PROPOSED POST AND RAIL SAFETY FENCE
- PROPOSED PEDESTRIAN GUARD RAILING
- PROPOSED LANDSCAPING BUND
- PUBLIC RIGHT OF WAY
- HIGHWAY BOUNDARY
- REDLINE BOUNDARY
- HS2 LAND TAKE
- EXISTING DITCH/WATERCOURSE
- DIVERTED DITCH/WATERCOURSE
- PROPOSED HEADWALL
- PROPOSED FLOOD STORAGE AREA

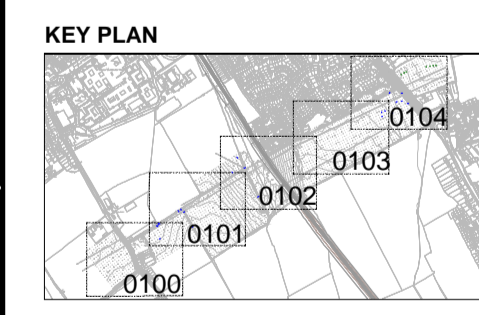

**FOR APPROVAL**

ISSUE/REVISION

IR	DATE	DESCRIPTION
A	02/10/19	FIRST ISSUE

SHEET TITLE  
 SOUTH EAST AYLESBURY  
 GENERAL ARRANGEMENT  
 SHEET 2 OF 5

SHEET NUMBER  
 6053364-ACM-00-XX-SKE-CE-0101

SCALE  
 AS SHOWN @ A1

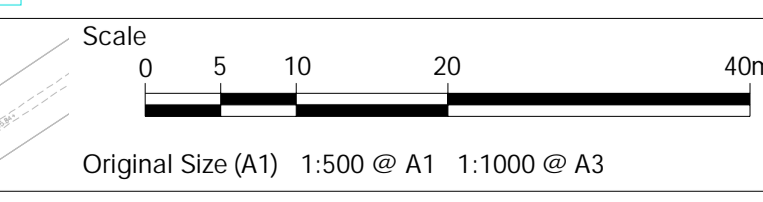

This drawing includes Ordnance Survey material with the permission of Ordnance Survey on behalf of The Controller of Her Majesty's Stationery Office. © Crown Copyright AECOM Limited, Licence Number AL100019139

This drawing has been prepared for the use of AECOM's client. It may not be used, modified, reproduced or relied upon by third parties, except as agreed by AECOM or as required by law. AECOM accepts no responsibility, and denies any liability, whatsoever, to any party that uses or relies on this drawing without AECOM's express written consent. Do not scale this document. All measurements must be obtained from the stated dimensions.

1. ALL DIMENSIONS ARE IN METRES UNLESS OTHERWISE STATED.
2. THIS DRAWING IS PRELIMINARY AND SUBJECT TO A SAFETY AUDIT.
3. HIGHWAY BOUNDARY BASED ON BCC INFORMATION DATED 06/03/17 AND SHOULD BE VERIFIED.
4. DRAWING BASED ON TOPOGRAPHICAL SURVEY REF. G 8673-REV 0, PRODUCED BY LASER SURVEYS, DATED 13/04/17.
5. INDICATIVE SIGNAGE AND ROAD MARKINGS SHOWN. SIGNAGE STRATEGY (INCL. DIRECTIONAL SIGNING) TO FORM PART OF THE DETAILED DESIGN.

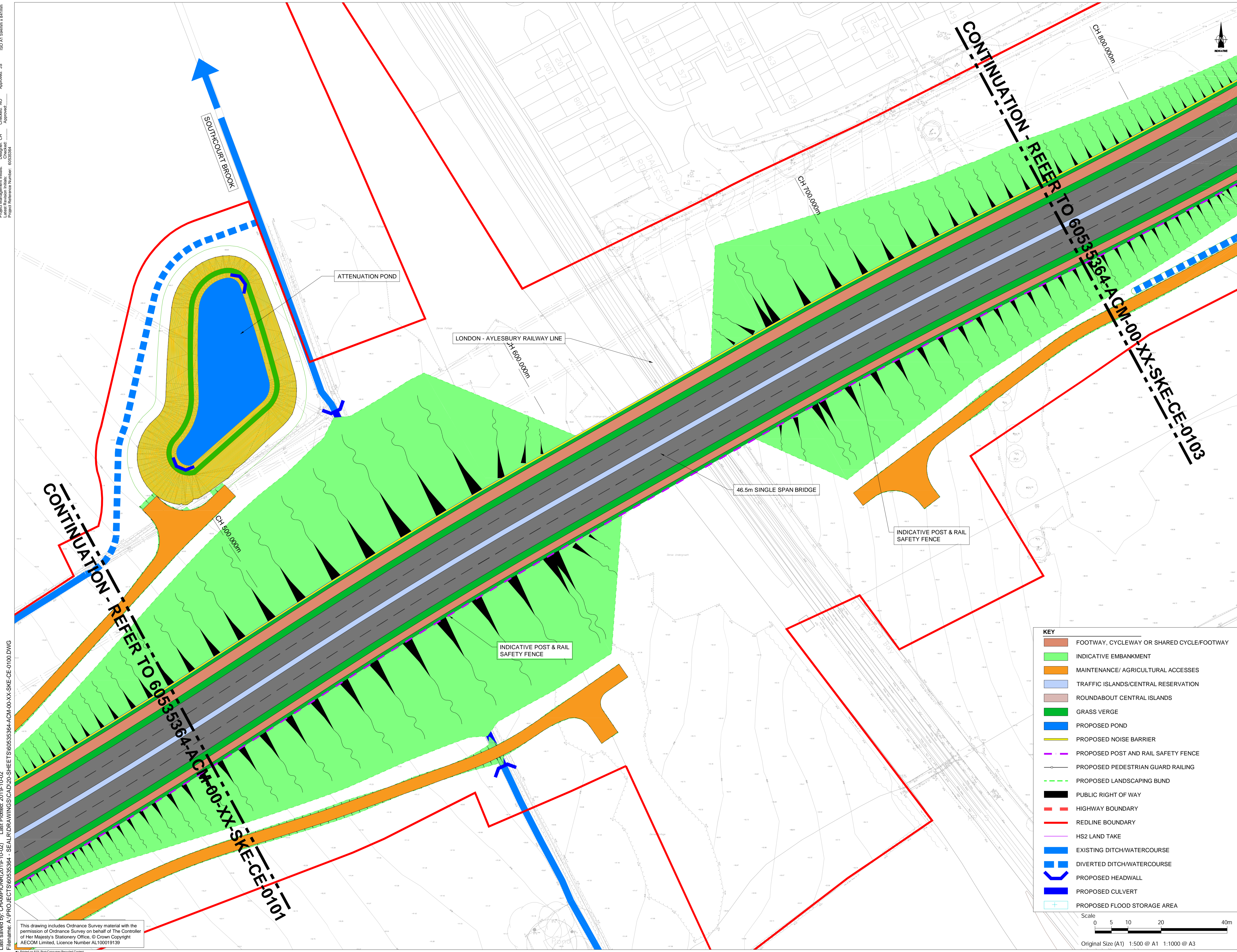

**KEY**

	FOOTWAY, CYCLEWAY OR SHARED CYCLE/FOOTWAY
	INDICATIVE EMBANKMENT
	MAINTENANCE/ AGRICULTURAL ACCESSES
	TRAFFIC ISLANDS/CENTRAL RESERVATION
	ROUNDABOUT CENTRAL ISLANDS
	GRASS VERGE
	PROPOSED POND
	PROPOSED NOISE BARRIER
	PROPOSED POST AND RAIL SAFETY FENCE
	PROPOSED PEDESTRIAN GUARD RAILING
	PROPOSED LANDSCAPING BUND
	PUBLIC RIGHT OF WAY
	HIGHWAY BOUNDARY
	REDLINE BOUNDARY
	HS2 LAND TAKE
	EXISTING DITCH/WATERCOURSE
	DIVERTED DITCH/WATERCOURSE
	PROPOSED HEADWALL
	PROPOSED CULVERT
	PROPOSED FLOOD STORAGE AREA

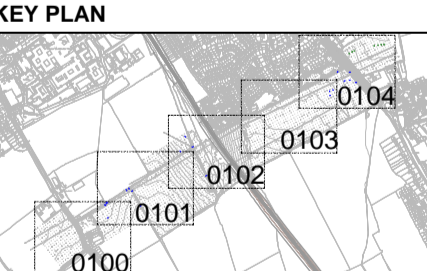

**FOR APPROVAL**

**ISSUE/REVISION**

NO	DATE	DESCRIPTION
A	02/10/19	FIRST ISSUE

**SHEET TITLE**

SOUTH EAST AYLESBURY  
GENERAL ARRANGEMENT  
SHEET 3 OF 5

**SHEET NUMBER**

60535364-ACM-00-XX-SKE-CE-0102

**SCALE**

AS SHOWN @ A1

Last saved by: CHAMPIONR(2019-10-02) Last Plotted: 2019-10-02  
 Filename: A:\PROJECTS\60535364-SEALR\DRAWINGS\CADD\20-SHEETS\60535364-ACM-00-XX-SKE-CE-0100.DWG  
 Project Reference Number: 60535364  
 Designer: CH  
 Checked: NO  
 Approved: JS  
 Project Management Details:  
 Latest Revision Details:  
 Project Reference Number: 60535364

This drawing includes Ordnance Survey material with the permission of Ordnance Survey on behalf of The Controller of Her Majesty's Stationery Office. © Crown Copyright AECOM Limited, Licence Number AL100019139

This drawing has been prepared for the use of AECOM's client. It may not be used, modified, reproduced or relied upon by third parties, except as agreed by AECOM or as required by law. AECOM accepts no responsibility, and denies any liability, whatsoever, to any party that uses or relies on this drawing without AECOM's express written consent. Do not scale this document. All measurements must be obtained from the stated dimensions.

1. ALL DIMENSIONS ARE IN METRES UNLESS OTHERWISE STATED.
2. THIS DRAWING IS PRELIMINARY AND SUBJECT TO A SAFETY AUDIT.
3. HIGHWAY BOUNDARY BASED ON BCC INFORMATION DATED 06/03/17 AND SHOULD BE VERIFIED.
4. DRAWING BASED ON TOPOGRAPHICAL SURVEY REF. G 8673-REV 0, PRODUCED BY LASER SURVEYS, DATED 13/04/17.
5. INDICATIVE SIGNAGE AND ROAD MARKINGS SHOWN. SIGNAGE STRATEGY (INCL. DIRECTIONAL SIGNING) TO FORM PART OF THE DETAILED DESIGN.

ISO A1 841mm x 594mm  
 Project Management: CH  
 Designer: CH  
 Checked: CH  
 Approved: CH  
 Project Reference Number: 60535364

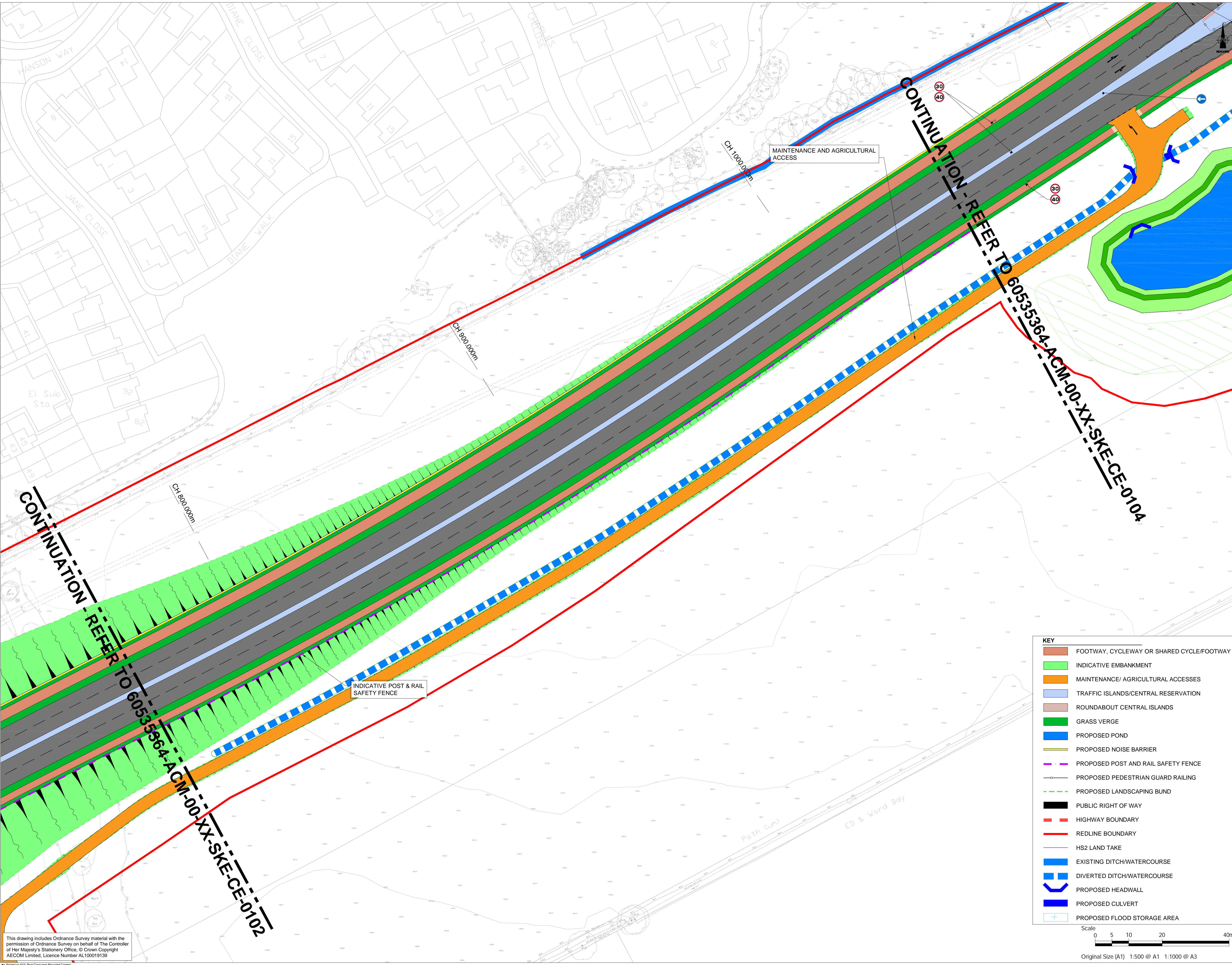

**KEY**

	FOOTWAY, CYCLEWAY OR SHARED CYCLE/FOOTWAY
	INDICATIVE EMBANKMENT
	MAINTENANCE/ AGRICULTURAL ACCESSES
	TRAFFIC ISLANDS/CENTRAL RESERVATION
	ROUNDABOUT CENTRAL ISLANDS
	GRASS VERGE
	PROPOSED POND
	PROPOSED NOISE BARRIER
	PROPOSED POST AND RAIL SAFETY FENCE
	PROPOSED PEDESTRIAN GUARD RAILING
	PROPOSED LANDSCAPING BUND
	PUBLIC RIGHT OF WAY
	HIGHWAY BOUNDARY
	REDLINE BOUNDARY
	HS2 LAND TAKE
	EXISTING DITCH/WATERCOURSE
	DIVERTED DITCH/WATERCOURSE
	PROPOSED HEADWALL
	PROPOSED CULVERT
	PROPOSED FLOOD STORAGE AREA

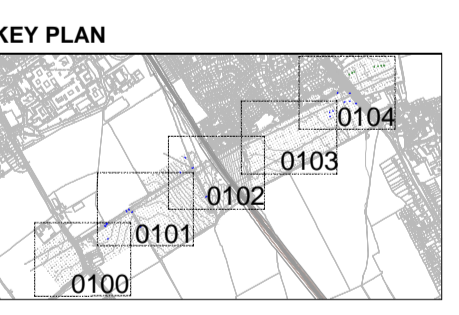

**FOR APPROVAL**

**ISSUE/REVISION**

NO	DATE	DESCRIPTION
A	02/10/19	FIRST ISSUE

**SHEET TITLE**

SOUTH EAST AYLESBURY  
GENERAL ARRANGEMENT  
SHEET 4 OF 5

**SHEET NUMBER**

60535364-ACM-00-XX-SKE-CE-0103

**SCALE**

AS SHOWN @ A1

This drawing includes Ordnance Survey material with the permission of Ordnance Survey on behalf of The Controller of Her Majesty's Stationery Office, © Crown Copyright AECOM Limited, Licence Number AL100019139

This drawing has been prepared for the use of AECOM's client. It may not be used, modified, reproduced or relied upon by third parties, except as agreed by AECOM or as required by law. AECOM accepts no responsibility, and denies any liability, whatsoever, to any party that uses or relies on this drawing without AECOM's express written consent. Do not scale this document. All measurements must be obtained from the stated dimensions.

ISO A1 594mm x 841mm  
 Checked: NO  
 Approved: JS  
 Designer: CH  
 Project Management Initials: LK  
 Latest Revision Initials: LK  
 Project Reference Number: 6053364

- NOTES**
- ALL DIMENSIONS ARE IN METRES UNLESS OTHERWISE STATED.
  - THIS DRAWING IS PRELIMINARY AND SUBJECT TO A SAFETY AUDIT.
  - HIGHWAY BOUNDARY BASED ON BCC INFORMATION DATED 06/03/17 AND SHOULD BE VERIFIED.
  - DRAWING BASED ON TOPOGRAPHICAL SURVEY REF. G 8673-REV 0, PRODUCED BY LASER SURVEYS, DATED 13/04/17.
  - INDICATIVE SIGNAGE AND ROAD MARKINGS SHOWN. SIGNAGE STRATEGY (INCL. DIRECTIONAL SIGNING) TO FORM PART OF THE DETAILED DESIGN.

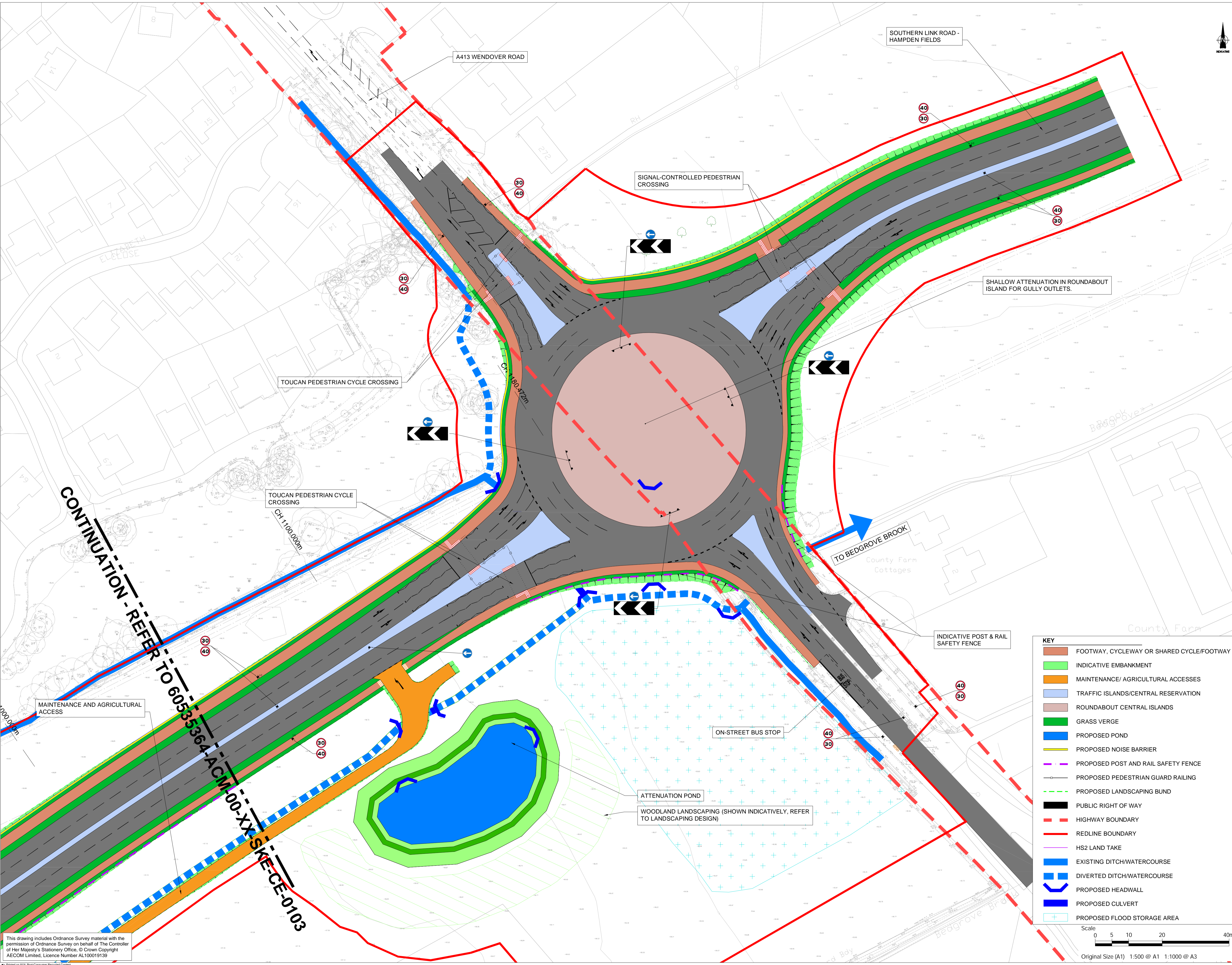

CONTINUATION - REFER TO 6053364-ACM-00-XX-SKE-CE-0100.DWG  
 6053364-ACM-00-XX-SKE-CE-0103

**KEY**

	FOOTWAY, CYCLEWAY OR SHARED CYCLE/FOOTWAY
	INDICATIVE EMBANKMENT
	MAINTENANCE/ AGRICULTURAL ACCESSES
	TRAFFIC ISLANDS/CENTRAL RESERVATION
	ROUNDABOUT CENTRAL ISLANDS
	GRASS VERGE
	PROPOSED POND
	PROPOSED NOISE BARRIER
	PROPOSED POST AND RAIL SAFETY FENCE
	PROPOSED PEDESTRIAN GUARD RAILING
	PROPOSED LANDSCAPING BUND
	PUBLIC RIGHT OF WAY
	HIGHWAY BOUNDARY
	REDLINE BOUNDARY
	HS2 LAND TAKE
	EXISTING DITCH/WATERCOURSE
	DIVERTED DITCH/WATERCOURSE
	PROPOSED HEADWALL
	PROPOSED CULVERT
	PROPOSED FLOOD STORAGE AREA

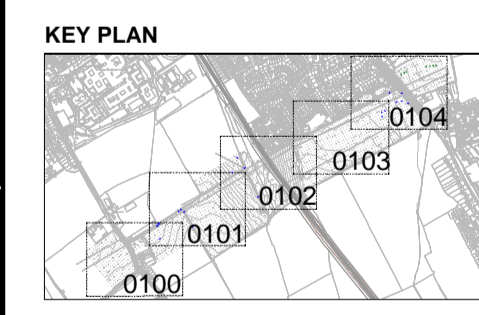

**FOR APPROVAL**

**ISSUE/REVISION**

IR	DATE	DESCRIPTION
A	02/10/19	FIRST ISSUE

**SHEET TITLE**

SOUTH EAST AYLESBURY GENERAL ARRANGEMENT SHEET 5 OF 5

**SHEET NUMBER**

6053364-ACM-00-XX-SKE-CE-0104

**SCALE**

AS SHOWN @ A1

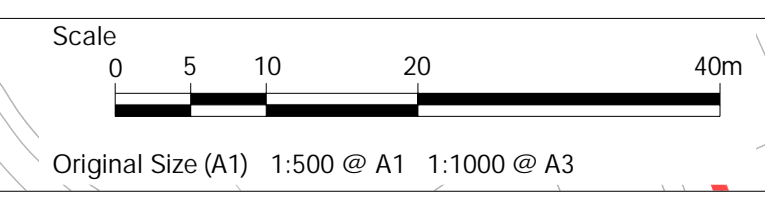

This drawing includes Ordnance Survey material with the permission of Ordnance Survey on behalf of The Controller of Her Majesty's Stationery Office. © Crown Copyright AECOM Limited, Licence Number AL100019139

This drawing has been prepared for the use of AECOM's client. It may not be used, modified, reproduced or relied upon by third parties, except as agreed by AECOM or as required by law. AECOM accepts no responsibility, and denies any liability, whatsoever, to any party that uses or relies on this drawing without AECOM's express written consent. Do not scale this document. All measurements must be obtained from the stated dimensions.